

# Slack Storage Module (SSM)

For use with FTTP Tight Buffered I/O Drop Cable

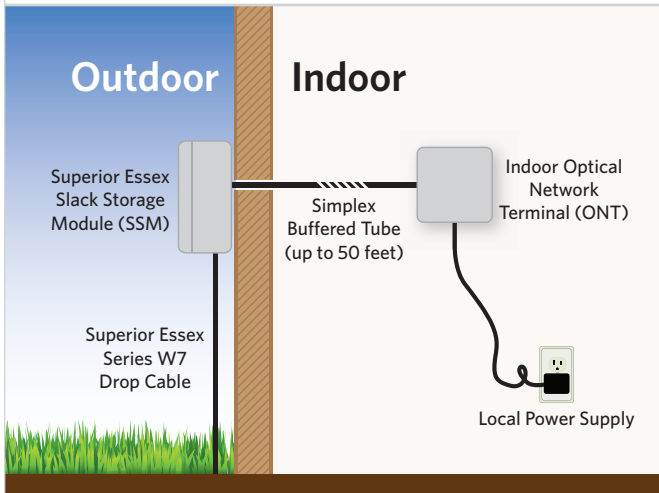

## PRODUCT AND SOLUTION DESCRIPTION

The Slack Storage Module (SSM) provides water-tight storage for up to 50 feet of excess simplex fiber cable at the side of an FTTP residence. The SSM is specifically designed for use with the Superior Essex tight buffered indoor/outdoor drop cable to provide a substantial cost savings for FTTP installations – around \$200 per connected location.\*

The SSM provides protection of excess simplex fiber and convenient outdoor access to the fiber if a splice is necessary in the future.

The combination of the SSM and tight buffered drop cable enables the Optical Network Terminal (ONT) to be located inside the premises without the need for a termination or splice point on the exterior of the home. Our unique tight buffered drop cable is actually two cables in one: a rugged 300-lb rated OSP drop cable with an internal flexible OFNR rated simplex cable. By simply removing the outer PVC jacket and strength rods, this cable can be easily transitioned to indoor use without a splice point between the ONT and pedestal or terminal closure. For that reason, a splice point or termination is no longer required at the side of the home.

By locating the ONT inside the premises, the power supply can be plugged into any convenient wall outlet, eliminating the cost of running power to the ONT and the need to hire an electrician – further reducing installation costs. Another cost-savings benefit when using our tight buffered simplex cable design is having the capability to create a faster and more accurate termination to an SC connector.

*\*Savings are realized from elimination of electrician costs, reduced cost for indoor ONT, and reduced cost for fiber splicing.*

## APPLICATIONS

- Fiber to the Home or Premises applications with indoor ONT

## SYSTEM SOLUTION BENEFITS

- Only one technician is required for complete installation (no electrician required)
- Tight buffered optical fiber offers easier and faster termination than loose fiber termination or fusion splicing
- SSM provides an inexpensive way to access and store excess fiber
- Enables use of indoor-rated ONT that is less costly than outdoor-rated ONT
- Enables use of indoor backup power supply that is less costly than outdoor rated power supply

## MODULE FEATURES

- Compact, easy-to-install enclosure design
- Weather-resistance enclosure with two levered latches and sealing gasket on the cover
- Drop cable grommet ports at top and bottom of enclosure
- Storage spool for 50 feet of fiber drop slack storage
- Cable tie provisions for both cable sheath and buffer jacket

## MODULE BENEFITS

- Reduces initial cost of installation
- Provides superior environmental protection from rain, ice, dust and insects
- Provides flexibility and diversity in routing drop cable
- Provides optimum fiber management and generous slack storage
- Provides rigid and secure drop cable attachment

## Slack Storage Module (SSM)

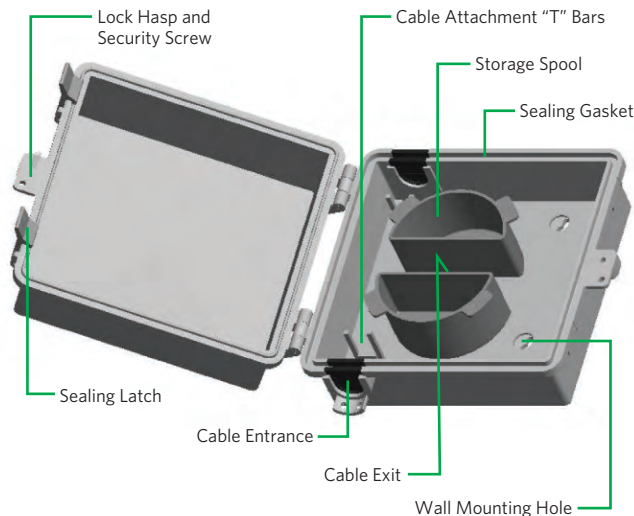

### MODULE SPECIFICATIONS

Dimensions in (mm)	Height: 6.7 (170) Width: 6.7 (170) Depth: 3.6 (92)
Weight lb (kg)	0.5 (0.23)
Material	ABS plastic
Material Color	Light grey
Material Thickness in (mm)	0.10 (2.5)
Cable Entry	Two (2) in One (1) out
Maximum I/O Drop Cable Diameter in (mm)	0.18 x 0.40 (4.6 x 10.2)
Installation	Wall
Locking Mechanism	Two (2) levered cover latches and captive pin-in-hex security screw
Standards Compliance	Designed to meet NEMA 3 rating for environmental protection

### MODULE PART NUMBER

Part Number	Description
SSM-2C000	FTTP Slack Storage Module (SSM)

## FTTP Tight Buffered Indoor/Outdoor Drop Series W7

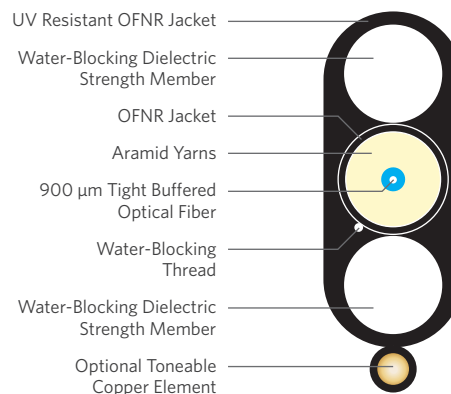

### CABLE SPECIFICATIONS

Simplex OFNR Nominal Diameter in (mm)	0.11 (2.9)
Simplex OFNR Bend Radius in (mm)	Install: 2.2 (56) Long Term: 1.1 (28)
Cable Bend Radius in (mm)	Install: 3.6 (91) Long Term: 1.8 (46)
Cable Tensile Load lbs (N)	Install: 300 (1,350) Long Term: 90 (405)
Maximum Span Length at 1% Sag ft (m)	Light Loading: 350 (101) Medium Loading: 275 (84) Heavy Loading: 150 (46)
Standards Compliance	Telcordia GR-20-CORE Telcordia GR-409-CORE RoHS-compliant

### CABLE ENVIRONMENTAL SPECIFICATIONS

Operation/Storage	-40°C to +70°C
Installation	-10°C to +70°C

### CABLE MACRO BENDING PERFORMANCE

10 Turns on 15 mm Radius Mandrel	ITU G 657 A	TeraFlex®
Macro bending loss @ 1550 nm	0.25 dB Max.	≤ 0.20 dB
Macro bending loss @ 1625 nm	1.00 dB Max.	≤ 0.50 dB
1 Turn on 10 mm Radius Mandrel	ITU G 657 A	TeraFlex
Macro bending loss @ 1550 nm	0.75 dB Max.	≤ 0.20 dB
Macro bending loss @ 1625 nm	1.50 dB Max.	≤ 0.50 dB

TeraFlex is an ITU G 657 A optical fiber that is completely compatible with ITU G 652 D optical fibers. TeraFlex exceeds the performance standards of ITU G 657 A as listed above.

### CABLE PART NUMBERS AND PHYSICAL CHARACTERISTICS

Part Number	Description	Nominal Dimensions in (mm)	Weight lbs/kft (kg/km)
W7001KU01	Universal Indoor/Outdoor FTTP	0.33 (8.2) x 0.18 (4.5)	29 (44)
W7001K101	Toneable Indoor/Outdoor FTTP	0.40 (10.2) x 0.18 (4.5)	31 (47)